

Unincorporated Services Committee Presentation

March 26, 2025



Measure X Phase 1 (Stations 7, 22, & 25)



Alameda County Fire Department
"Dedicated to superior service."

Measure X Bond Summary

- November 2020 – ACFD Fire Safety Bond (Measure X) approved by community
- \$90M in general obligation bonds to repair, upgrade, and replace outdated fire stations in unincorporated communities of Ashland, Castro Valley, and San Lorenzo



Alameda County Fire Department
"Dedicated to superior service."

Program Summary

- Stations under first phase of program:
 - Fire Station 7 (Castro Valley)
 - Fire Station 25 (Castro Valley)
 - Fire Station 22 (San Lorenzo)
- Fire Station Builds are being constructed using Design-Build method
- All Stations will incorporate public art
 - Community will be an integral part of the art selection committees



Alameda County Fire Department
"Dedicated to superior service."

Fire Station 7 (Palomares Hill)

- 6855 Villareal Dr
- Station is being built adjacent to existing fire station
- Primary apparatus:
 - Type 1 engine
- Daily Staffing:
 - (3) personnel

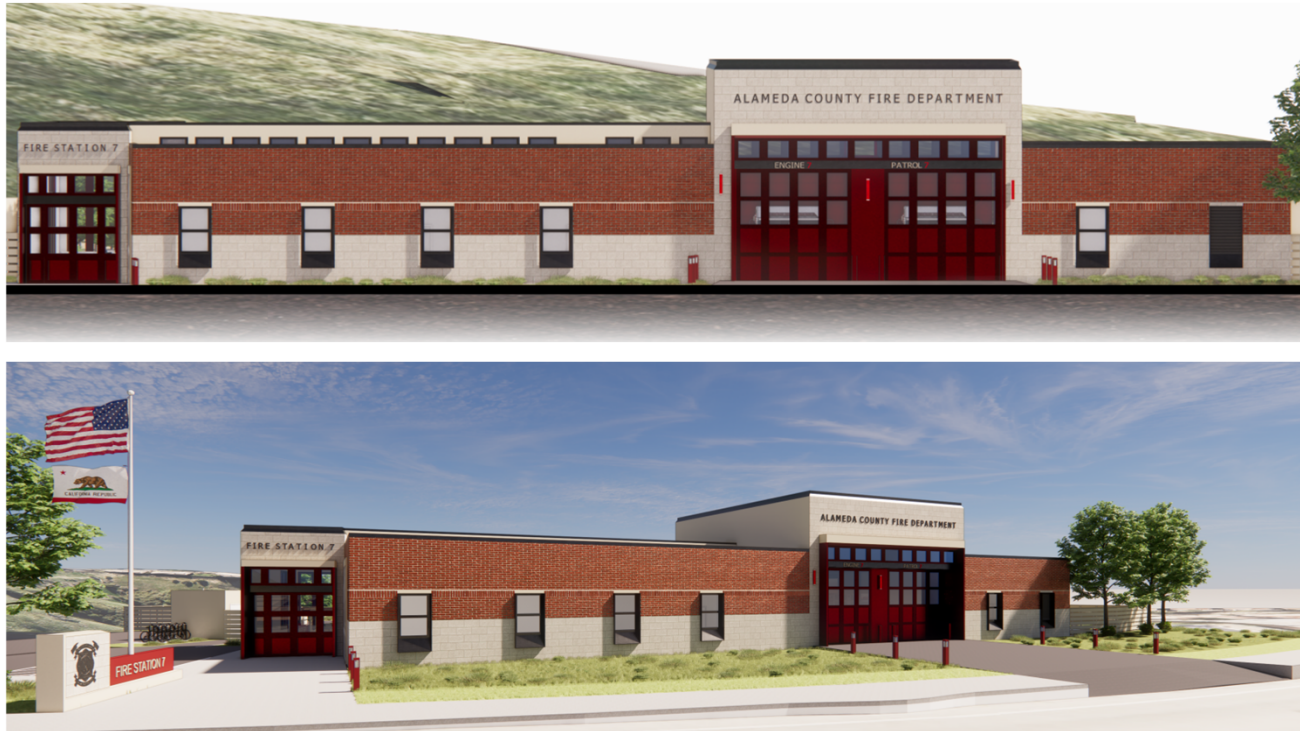

Alameda County Fire Department
"Dedicated to superior service."

Current Status/Next Steps – Station 7

- Re-zoning of parcel has been approved by Board of Supervisors on March 13th Board meeting
- Design Builder has started the process to continue the design development from the Bridging Documents
- Initial phases of permitting process

Fire Station 25 Castro Valley

- 20336 San Miguel Ave
- Station being built on same site as current station
- Primary apparatus:
 - Type 1 engine
 - Tiller truck
 - Battalion Chief
- Daily Staffing:
 - (8) personnel



Alameda County Fire Department
"Dedicated to superior service."

Current Status/Next Steps – Station 25

- Voluntary Remedial Action Agreement has been executed with ACEHD. The Design Builder's environmental consultant has engaged with ACEHD to further evaluate potential mitigation measures required for the site.
- Lease agreement is in place with Castro Valley Sanitary for lease of the administration building for the Interim Fire Station 25
- Design Builder has started the process to continue the design development from the Bridging Documents

Fire Station 22 San Lorenzo

- 587 Paseo Grande
- Station being built on new site
- Primary apparatus:
 - Type 1 engine
- Daily Staffing:
 - (3) personnel



Current Status/Next Steps – Station 22

- Phase II Environmental Site Assessment has been submitted to ACEHD for review and determination of next steps for site mitigation
- Coordination with PG&E to remove the existing power pole on site
- RFP for Design Build Entity services expected to be released in May

Architectural Character

- Modernized “traditional” Fire Stations
- Unified exterior finishes
- Unique features by Station and neighborhood/site

FS 25



FS 22



FS 7



Alameda County Fire Department
"Dedicated to superior service."

Schedule

Milestone Activity	Station 7	Station 25	Station 22
Complete Bridging Documents	May 2024	May 2024	May 2025*
Design Build Entity (DBE) RFP/Selection	DBE on boarded January 2025	DBE on boarded January 2025	May 2025 – September 2025
DBE Design Phase/Permitting	February 2025 – January 2026	February 2025 – January 2026	October 2025 – September 2026
Construction	November 2025 – October 2026	January 2026 – January 2027	August 2026 – September 2027



Alameda County Fire Department
"Dedicated to superior service."

*Pending review by ACEHD

Public Art Program

- Partnership with the Office of the Alameda County Arts Commission
- Art type and site are being identified by ACFD, Arts Commission and design team
- Opportunities for community involvement:
 - Artist Selection Committee
 - Feedback on Artwork Proposals
- Specific info about community involvement will be shared at a future date
- One artist will be selected from the Art Commission's prequalified list of artists
- Art project will follow the Arts Commission's standard process including close collaboration between ACFD and Arts Commission
- Updates will be provided to Municipal Advisory Councils and community groups.
- Reviews and approvals by the Alameda County Public Art Advisory Committee, Members of the Alameda County Arts Commission and Board of Supervisors.



Alameda County Fire Department
"Dedicated to superior service."

Questions or Feedback?



Alameda County Fire Department
"Dedicated to superior service."